



www.EastPointStudios.com

404.376.2242

East Point Studios, Ltd. Rates

Please find the lease rates below with the term lease equal to or greater than two-months. Inquire separately for lease rates with term length requiring less than two months.

Whole Facility (21,620 SF) - Utilities not included*	Lease Rates
Monthly Rental	\$12,540
Weekly	\$3,135
Daily	\$528

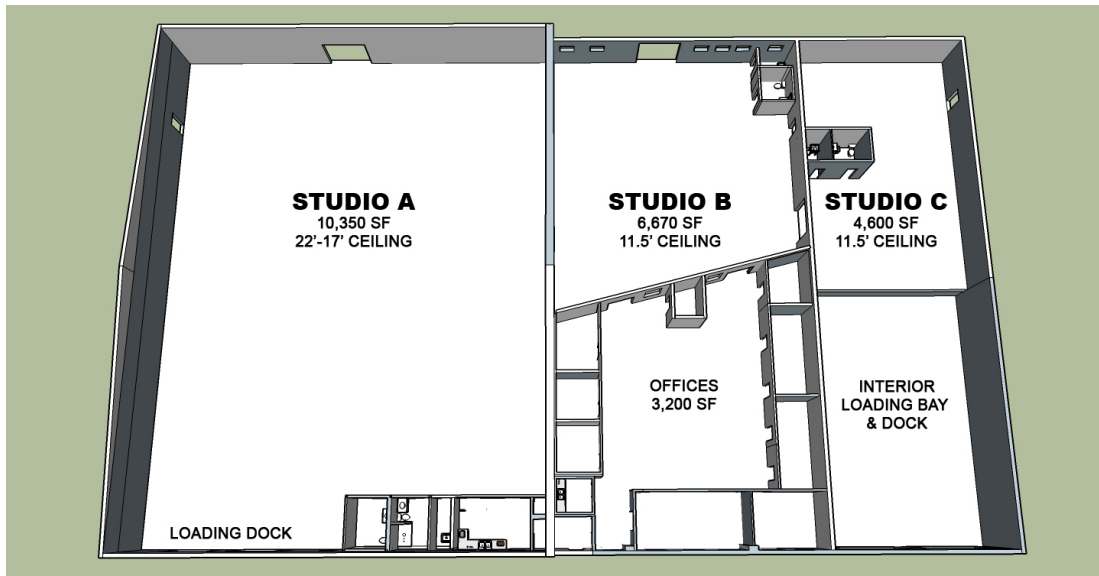

Studio Rates if Leased Separately Utilities not included*	Studio A 10,350 sq. ft.	Studio B 6,670 sq. ft.	Studio C 4,600 sq. ft.
Monthly Rental	\$6,830	\$4,400	\$3,030
Weekly	\$1,708	\$1,100	\$760
Daily - Seven Day Wk (+18%)	\$288	\$186	\$128

East Point Studios, Ltd. Specifications

*See Floor Plan Graphic

<p>Studio A 10,350 sq. ft.</p>	<p>90' x 115' concrete flooring 20-ft ceiling in the center (gym-like structure) Two 10x10 dock height loading bays Kitchenette Two restrooms facilities/one with shower Utility/Wash sink room Security code panel entrance on Sampler Road side</p>
<p>Studio B 6,670 sq. ft.</p>	<p>58' x 115' concrete flooring 3200 SF of Production Offices with Kitchenette, conference room, lockable offices, HVAC, WiFi ready** 3470 SF Open floor space Alarm Monitoring System with keypad entry Restroom facility and utility sink room Natural brick on front and back walls with 8' high warehouse windows</p>
<p>Studio C 4,600 sq. ft.</p>	<p>40' x 115' concrete flooring Features two interior dock high bays (sloping floor) Factory-style windows across back wall with natural exposed brick Security code panel side door entrance from Sylvan Road side parking lot Large factory swing door separating Studio B and C Exposed pipe 10ft across in flat floor section</p>
<p>Parking</p>	<p>Crew parking for approximately (30) total mid-size vehicles with the combination of Sylvan Road and Sampler Way parking areas.</p>

*Utilities Not Included – City of East Point Water & Electric, Waste Management (4-yard) weekly pickup, and Atlanta Natural Gas invoiced separately.
